



TECHNICAL DATA - GL.01

PHOTOVOLTAIC GLASS		58 x 79	
GL.01		L	Vision (20%)
Electrical data test conditions (STC)			
Nominal peak power	84	P _{mpp} (Wp)	
Open-circuit voltage	155.44	V _{oc} (V)	
Short-circuit current	0.97	I _{sc} (A)	
Voltage at nominal power	106.77	V _{mpp} (V)	
Current at nominal power	0.79	I _{mpp} (A)	
Power tolerance not to exceed	±5	%	
STC: 1000 w/m ² , AM 1.5 and a cell temperature of 25°C, stabilized module state.			
Mechanical description			
Length	58	inches	
Width	79	inches	
Thickness	1.21	inches	
Surface area	26.71	sqf	
Weight	235	Lbs	
Cell type	α-Si	Thin Film	
Transparency degree	L	Vision (20%)	
Front Glass	5/32"	Tempered Glass	
PV Active Glass	1/8 "	Float Glass	
Rear Glass	5/32"	Tempered Glass	
Gas Spacer	1/2"	Air Chamber	
Inner Glass	1/4"	Tempered Glass Low-e	
Thickness encapsulation	3,04 mm	PVB Foils	
Category / Color code			
Junction Box			
Protection	IP65		
Wiring Section	2,5 mm ² or 4,0 mm ²		
Limits			
Maximum system voltage	600	V _{sys} (V)	
Operating module temperature	-40...+85	°C	
Temperature Coefficients			
Temperature Coefficient of P _{mpp}	-0,19	%/°C	
Temperature Coefficient of V _{oc}	-0,28	%/°C	
Temperature Coefficient of I _{sc}	+0,09	%/°C	

* All technical specifications are subject to change without notice by Onyx Solar

global leader in building integrated photovoltaic glass





TECHNICAL DATA - GL.01

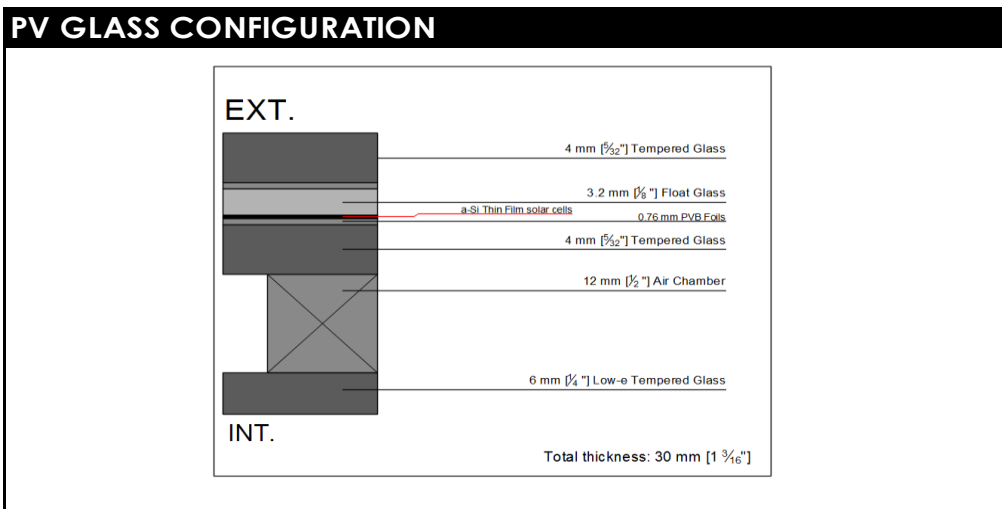

GLASS PROPERTIES	Onyx Equivalent Glass
Solar Factor/SHGC	32.00%
Light Transmission	16.30%
UV Transmission	< 1%
Light Reflection	8%
U-value [Btu/h ft ² °F]	0.28
Peak Power [Wp/sqf]	3.2

global leader in building integrated photovoltaic glass





TECHNICAL DATA - GL.02

PHOTOVOLTAIC GLASS		51 x 79
GL.02	L	Vision (20%)
Electrical data test conditions (STC)		
Nominal peak power	84	P _{mpp} (Wp)
Open-circuit voltage	155.44	V _{oc} (V)
Short-circuit current	0.97	I _{sc} (A)
Voltage at nominal power	106.77	V _{mpp} (V)
Current at nominal power	0.79	I _{mpp} (A)
Power tolerance not to exceed	±5	%
STC: 1000 w/m², AM 1.5 and a cell temperature of 25°C, stabilized module state.		
Mechanical description		
Length	51	inches
Width	79	inches
Thickness	1.21	inches
Surface area	26.71	sqf
Weight	235	Lbs
Cell type	α-Si	Thin Film
Transparency degree	L	Vision (20%)
Front Glass	5/32"	Tempered Glass
PV Active Glass	1/8 "	Float Glass
Rear Glass	5/32"	Tempered Glass
Gas Spacer	1/2"	Air Chamber
Inner Glass	1/4"	Tempered Glass Low-e
Thickness encapsulation	3,04 mm	PVB Foils
Category / Color code		
Junction Box		
Protection	IP65	
Wiring Section	2,5 mm ² or 4,0 mm ²	
Limits		
Maximum system voltage	600	V _{sys} (V)
Operating module temperature	-40...+85	°C
Temperature Coefficients		
Temperature Coefficient of P _{mpp}	-0,19	%/°C
Temperature Coefficient of V _{oc}	-0,28	%/°C
Temperature Coefficient of I _{sc}	+0,09	%/°C

*All technical specifications are subject to change without notice by Onyx Solar

global leader in building integrated photovoltaic glass





TECHNICAL DATA - GL.02

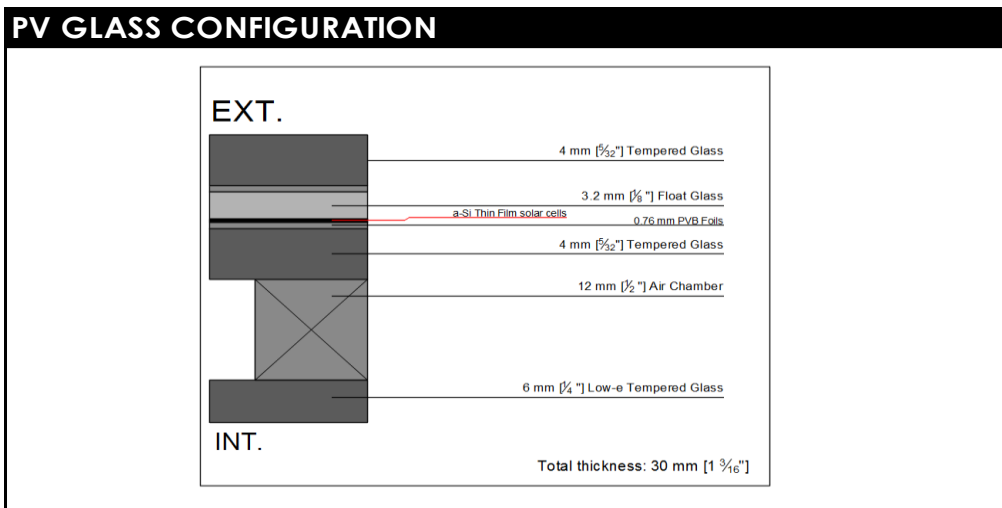
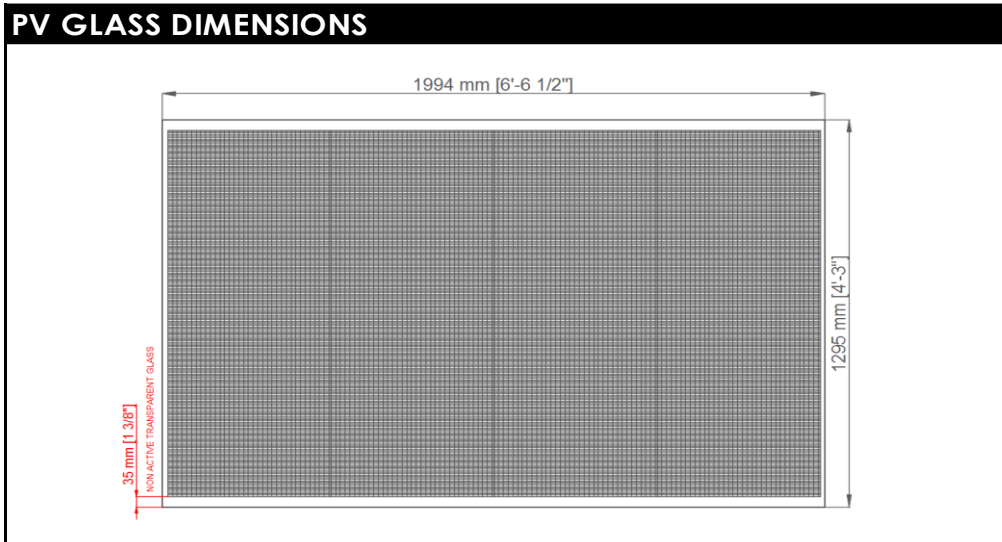

GLASS PROPERTIES	Onyx Equivalent Glass
Solar Factor/SHGC	32.00%
Light Transmission	16.30%
UV Transmission	< 1%
Light Reflection	8%
U-value [Btu/h ft ² °F]	0.28
Peak Power [Wp/sqf]	3.2

global leader in building integrated photovoltaic glass

