



TECHNICAL DATA - GL.01

PHOTOVOLTAIC GLASS		62 x 84
GL.01		L Vision (20%)
Electrical data test conditions (STC)		
Nominal peak power	114	P _{mpp} (Wp)
Open-circuit voltage	166,35	V _{oc} (V)
Short-circuit current	1,23	I _{sc} (A)
Voltage at nominal power	114,26	V _{mpp} (V)
Current at nominal power	1,00	I _{mpp} (A)
Power tolerance not to exceed	±5	%
STC: 1000 w/m², AM 1.5 and a cell temperature of 25°C, stabilized module state.		
Mechanical description		
Length	62	inches
Width	84	inches
Thickness	1,77	inches
Surface area	36,16	sqf
Weight	467	Lbs
Cell type	α-Si	Thin Film
Transparency degree	L	Vision (20%)
Front Glass	1/4"	Tempered Glass
PV Active Glass	1/8 "	Float Glass
Rear Glass	1/4"	Tempered Glass
Gas Spacer	5/8"	Air Chamber
Inner Glass	5/32"	Tempered Glass Low-e
Inner Glass	1/4"	Tempered Glass
Thickness encapsulation	3,04 mm	PVB Foils
Category / Color code		
Junction Box		
Protection	IP65	
Wiring Section	2,5 mm ² or 4,0 mm ²	
Limits		
Maximum system voltage	600	V _{sys} (V)
Operating module temperature	-40...+85	°C
Temperature Coefficients		
Temperature Coefficient of Pmpp	-0,19	%/°C
Temperature Coefficient of Voc	-0,28	%/°C
Temperature Coefficient of Isc	+0,09	%/°C

* All technical specifications are subject to change without notice by Onyx Solar

global leader in building integrated photovoltaic glass





TECHNICAL DATA - GL.01

PV GLASS DIMENSIONS

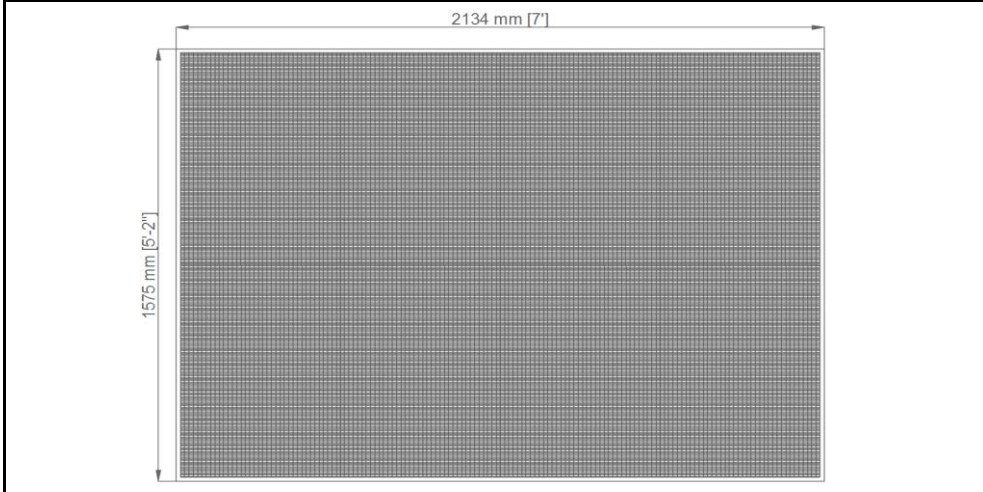

PV GLASS CONFIGURATION

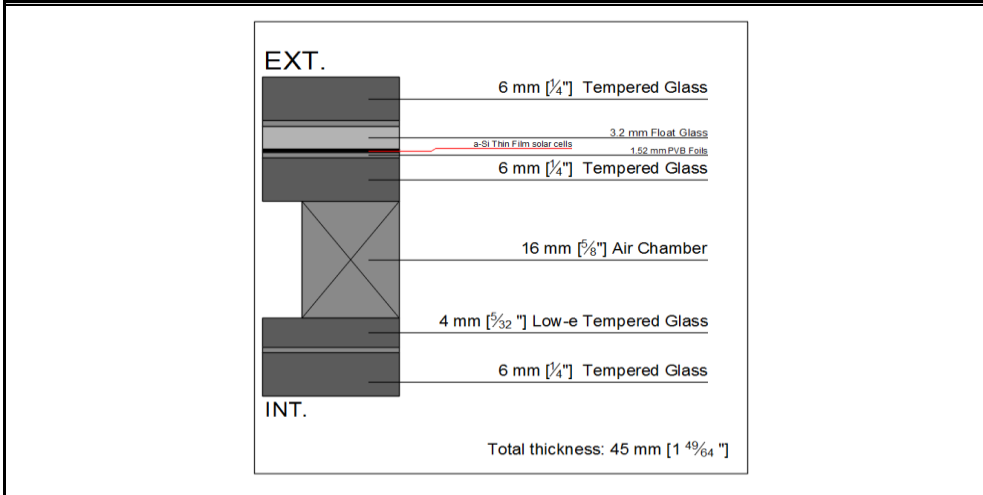

GLASS PROPERTIES	Onyx Equivalent Glass
Solar Factor/SHGC	12,00%
Light Transmission	16.30%
UV Transmission	< 1%
Light Reflection	8%
U-value [Btu/h ft ² °F]	0,23
Peak Power [Wp/sqf]	3,2

global leader in building integrated photovoltaic glass

